



Wheelchair — Model : H-WC704B

1. Getting to know your product

Wheelchair model H-WC704B made from Chrome plating steel. It foldable, safety, easy to use and suitable for elder and Mobility and Physical impairments

The wheelchair was designed with care for for safety and patient can move by themselves such as..

- Hand Rim was designed to help patients can move by themselves easier.

- Hand brake help caregiver can stop the wheelchair in emergency time.

- Foldable footplate and Calf leg strap was designed for comfortable. etc.

- The seat is made of artificial leather

2. Signs and symbols

The following symbols are used in these instructions for use, on the packaging and on the type plate for the device and accessories:



Caution :Warning instruction indicating a risk of injury or damage to health.



Warning : Safety note indicating possible damage to the unit/accessory.



Note : Note on important information

WHEELCHAIR

3. Description

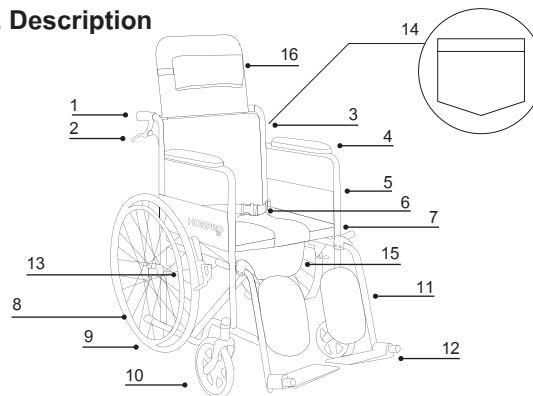

- | | | |
|----------------|-----------------|--------------------|
| 1. Hand | 7. Seat | 13. Hand Rim |
| 2. Handbrake | 8. Wheel brake | 14. Backrest Bag |
| 3. Backrest | 9. Back wheel | 15. Capacity |
| 4. Armrest | 10. Front wheel | 16. Head restraint |
| 5. Side panel | 11. Calf leg | |
| 6. Safety belt | 12. Footrest | |

4. For use

1. Foldable footrest

For safety and easy to use the footrest was designed to foldable beside the wheelchair and can be folded up.



2. Hand Rim

Hand Rim was designed for help patient can move by themselves easier.



WHEELCHAIR

3. Wheel brake

To protect the wheelchair moving, please pull the wheel brake.



4. Handbrake

For help caregiver can stop the wheelchair in emergency time.



5. Tipping lever

The Tipping lever was designed for help caregiver can lift the wheelchair easier.



6. Safety belt

Please fasten seat belt for safe.



5. Opening and folding the wheelchair

1. Opening the wheelchair

Hold the armrest on both side then push it down.



2. Folding the wheelchair

The wheelchair footplates should be lifted to the vertical position. Grip the front edge of the seat upholstery and pull upwards. The crossbars of the wheelchair will come together closing the wheelchair.



6. Caution

1. Maximum weight — 100 kg.



2. Speed : Should not fast to 3-5 km/hr.



WHEELCHAIR

3. Please fold the footrest
before stand up.



Should be used carefully to reduces the risk of injury.

7. Specification

Type	Wheelchair
Model	H-WC704B
Material	Frame : Chrome plating steel Seat : PVC leather
Color	Black
Capacity	5 L.
Folding size	35 x 127 x 120 cm.
Unfold size	63 x 127 x 120 cm.
Seat	25 inches : (D) 40 x (W) 50 cm.

WHEELCHAIR

Front wheel (Diameter)	8 inches
Back wheel (Diameter)	24 inches
Max weight	100 kg.
Self weight	30 kg.



Manufacturer : Foshan Nanhai KJT Rehabilitation Equipment co., ltd

WHEELCHAIR

HOSPRO

Wheelchair
Model H-WC704B

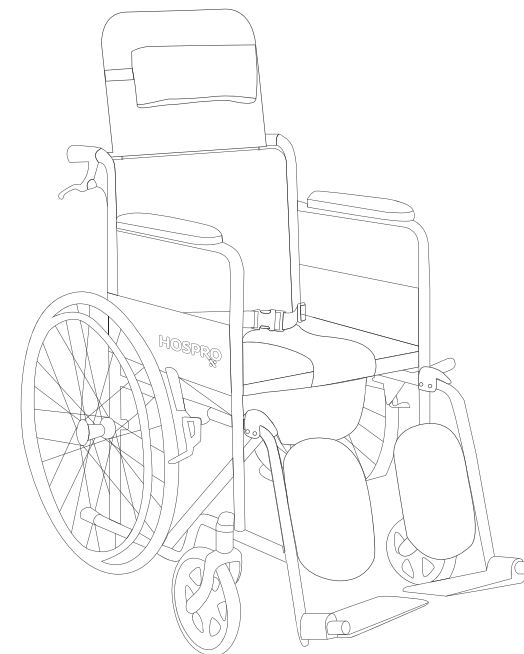

WHEELCHAIR